



NC DEPARTMENT OF TRANSPORTATION
 DIVISION OF HIGHWAYS
 BRIDGE MANAGEMENT UNIT

ATTENTION

PRIORITY MAINTENANCE ISSUED ON NON BEARING
 JOISTS
 SHORED STRUCTURE

BRIDGE INSPECTION REPORT

INSPECTION TYPE: Routine Inspection

COUNTY SAMPSON BRIDGE NUMBER 810233 INSPECTION CYCLE 2 YRS
 ROUTE SR1742 ACROSS SIX RUN CREEK M.P. 0

LOCATION 0.6 MI.N.JCT SR1740

SUPERSTRUCTURE RC FLOOR/TIMBER JOISTS(STD.BMD-10)

SUBSTRUCTURE E.BTS&BT:TIM.CAPS/TIM.PILES;CRUTCH ADDED @E.BTS.

SPANS 1@17'6;1@18'2

LONGITUDE 78° 15' 49.0" LATITUDE 35° 8' 41.7"

PRESENT CONDITION POOR INVENTORY RATING H5-01

INSPECTION DATE 07/22/2010 OPERATING RATING H8-01

PRESENT POSTING SV 25 TTST 99 WL 25 TONS PROPOSED POSTING SV 25 TTST LGW

COMPUTER UPDATE 8-19-10 ANALYSIS DATE 8-10-10

POSTING LETTER DATE _____ SUFFICIENCY RATING _____

OTHER SIGNS PRESENT 4 DELINEATORS



LOOKING NORTH

SIGN NOTICE ISSUED FOR	NUMBERED REQUIRED
<u>No</u> WEIGHT LIMIT	_____
<u>No</u> DELINEATORS	_____
<u>No</u> NARROW BRIDGE	_____
<u>No</u> ONE LANE BRIDGE	_____
<u>No</u> LOW CLEARANCE	_____

NATIONAL BRIDGE INVENTORY----- STRUCTURE INVENTORY AND APPRAISAL Run Date: 08/19/2010

IDENTIFICATION

(1) STATE NAME -NORTH CAROLINA BRIDGE 810233
 (8) STRUCTURE NUMBER(FEDERAL) 000000001630233
 INVENTORY ROUTE (ON/UNDER) - ON 131017420
 (2) STATE HIGHWAY DEPARTMENT DISTRICT 3
 (3) COUNTY CODE 163 (4) PLACE CODE 00000
 (6) FEATURE INTERSECTED - SIX RUN CREEK
 (7) FACILITY CARRIED SR1742
 (9) LOCATION 0.6 MI.N.JCT SR1740
 (11)MILEPOINT 0
 (16)LAT 35° 8' 41.7" (17)LONG 78° 15' 49.0"
 (98)BORDER BRIDGE STATE CODE PCT SHARE
 (99)BORDER BRIDGE STRUCTURE NO

SUFFICIENCY RATING = 26
 STATUS = Structurally Deficient

CLASSIFICATION CODE

(112)NBIS BRIDGE SYSTEM - YES
 (104)HIGHWAY SYSTEM NON NHS Route 0
 (26) FUNCTIONAL CLASS - Local 09
 (100)STRAHNET HIGHWAY - Not a STRAHNET Route 0
 (101)PARALLEL STRUCTURE - No Parallel Structure N
 (102)DIRECTION OF TRAFFIC - 2-way Traffic 2
 (103)TEMPORARY STRUCTURE - Temporary T
 (110)DESIGNATED NATIONAL NETWORK - Not Part of 0
 (20) TOLL On Free Road 3
 (31) MAINTAIN - State Highway Agency 01
 (22) OWNER - State Highway Agency 01
 (37) HISTORICAL SIGNIFICANCE - Not Eligible 5

STRUCTURE TYPE AND MATERIAL

(43) STRUCTURE TYPE MAIN: Wood or Timber
 TYPE - Stringer Multibeam or Girder CODE 702
 (44) STRUCTURE TYPE APPR :
 TYPE - CODE
 (45) NUMBER OF SPANS IN MAIN UNIT 2
 (46) NUMBER OF APPROACH SPANS
 (107)DECK STRUCTURE TYPE - Concrete cast-in-place CODE 1
 (108)WEARING SURFACE / PROTECTIVE SYSTEM :
 (A) TYPE OF WEARING SURFACE - Concrete CODE 1
 (B) TYPE OF MEMBRANE - None CODE 0
 (C) TYPE OF DECK PROTECTION - None CODE 0

CONDITION CODE

(58) DECK 5
 (59) SUPERSTRUCTURE 6
 (60) SUBSTRUCTURE 4
 (61) CHANNEL & CHANNEL PROTECTION 7
 (62) CULVERTS N

LOAD RATING AND POSTING CODE

(31) DESIGN LOAD Other or Unknown 0
 (64) OPERATING RATING - HS-1 101
 (66) INVENTORY RATING - HS-1 101
 (70) BRIDGE POSTING - Posting Required 4
 (41) STRUCTURE OPEN, POSTED ,OR CLOSED P
 DESCRIPTION - Posted for Load

AGE AND SERVICE

(27) YEAR BUILT 1952
 (106)YEAR RECONSTRUCTED
 (42) TYPE OF SERVICE : ON - Highway
 UNDER - Waterway CODE 15
 (28) LANES: ON STRUCTURE 2 UNDER STRUCTURE
 (29) AVERAGE DAILY TRAFFIC 500
 (30) YEAR OF ADT 2008 (109) TRUCK ADT PCT 6 %
 (19) BYPASS OR DETOUR LENGTH 8 MI

APPRAISAL CODE

(67) STRUCTURAL EVALUATION 2
 (68) DECK GEOMETRY 4
 (69) UNDERCLEARANCES,VERTI & HORIZ N
 (71) WATERWAY ADEQUACY 8
 (72) APPROACH ROADWAY ALIGNMENT 8
 (36) TRAFFIC SAFETY FEATURES 0000
 (113)SCOUR CRITICAL BRIDGES U
 SCOUR PLAN OF ACTION

GEOMETRIC DATA

(48) LENGTH OF MAXIMUM SPAN 18 FT
 (49) STRUCTURE LENGTH 36 FT
 (50)CURB OR SIDEWALK: LEFT 0.8 FT RIGHT 0.8 FT
 (51) BRIDGE ROADWAY WIDTH CURB TO CURB 24.0 FT
 (52) DECK WIDTH OUT TO OUT 25.3 FT
 (32) APPROACH ROADWAY WIDTH (W/SHOULDERS) 18.0 FT
 (33) BRIDGE MEDIAN - No Median CODE 0
 (34) SKEW 0° (35) STRUCTURE FLARED NO
 (10) INVENTORY ROUTE MIN VERT CLEAR 99 FT 99 IN
 (47) INVENTORY ROUTE TOTAL HORIZ CLEAR 24.0 FT
 (53) MIN VERT CLEAR OVER BRIDGE RDWY 99 FT 99 IN
 (54) MIN VERT UNDERCLEAR REF Not a Highway or Railroad
 (55) MIN LAT UNDERCLEAR RT REF Not a Highway or Railroad 99.9 FT
 (56) MIN LAT UNDERCLEAR LT REF - 0.0 FT

PROPOSED IMPROVEMENTS

(75) TYPE OF WORK - CODE
 (76) LENGTH OF STRUCTURE IMPROVEMENT 0 FT
 (94) BRIDGE IMPROVEMENT COST
 (95) ROADWAY IMPROVEMENT COST
 (96) TOTAL PROJECT COST
 (97) YEAR OF IMPROVEMENT COST ESTIMATE 20
 (114)FUTURE ADT 1000 (115) YEAR FUTURE ADT 2025

NAVIGATION DATA

(38) NAVIGATION CONTROL - No Navigational Control CODE 0
 (111)PIER PROTECTION - Not Applicable CODE
 (39) NAVIGATION VERTICAL CLEARANCE 0
 (116)VERT - LIFT BRIDGE NAV MIN VERT CLEAR
 (40) NAVIGATION HORIZONTAL CLEARANCE 0

INSPECTIONS

(90) INSPECTION DATE 07/22/2010
 (92) CRITICAL FEATURE INSPECTION : (93) CFI DATE
 A) FRACTURE CRIT DETAIL - NO A)
 B) UNDERWATER INSP - YES 48Mo B) 07/01/2010
 C) OTHER SPECIAL INSP NO C)
 SCOUR

BRIDGE INSPECTION RECORD AND SUMMARY

INSPECTION TYPE Routine Inspection
 BRIDGE NO. 810233 COUNTY SAMPSON ROUTE SR1742 OVER SIX RUN CREEK
 STRUCTURE TYPE RC FLOOR/TIMBER JOISTS(STD.BMD-10)
 ROUTE ORIENTATION S - N SPANS 1@17'6;1@18'2

EVALUATION CODE: 0-2 CRITICAL, 3 & 4 POOR, 5 & 6 FAIR, 7-9 GOOD

INSPECTION ITEM				ITEM 61			
DECK ITEMS			GRADES				
1. WEARING SURFACE				45. CHANNEL & CHANNEL PROT.	a. WATERWAY		7
2. DECK NO. OF EA TYPE					b. ALIGNMENT		8
SPN GRADE					c. SCOUR		8
RATES SI & A ITEM 58					d. SLOPE PROT., RIP-RAP, DIKES, ETC.		
3. RAILING				50. APPROACH ROADWAY CONDITION			6
a. CONCRETE				51. APPROACH SLABS			
b. TIMBER				52. PAINT SYSTEM			CODE
c. ALUMINUM				53. UTILITIES			
d. STEEL				54. RESPONSE TO LIVE LOAD			7
4. CURBS, WHEELGUARDS, PARAPETS, MEDIANS				55. ESTIMATED REMAINING LIFE			8
5. WALKWAYS (ON OR ATTACHED TO STRUCTURE)				60. REGULATORY SIGN NOTICE ISSUED			NO
6. DECK EXP JTS. OR DEVICES. NO. OF EACH				61. PROMPT-ACTION NOTICE ISSUED			YES
a. STEEL PL OR FINGER				62. PRESENTLY POSTED			YES
b. MISC PREFAB				63. TOT. FIELD INSP TIME (INCLUDE WRITE UP)(MAN HR)			7
c. COMPRESSION SEAL				64. TOTAL SNOOPER INSP. TIME (HRS)			0
d. STANDARD JOINTS				65. TOTAL TRAFFIC CONTROL TIME (MAN HRS)			0
e. OPEN JOINTS							
7. DECK DEBRIS (INCLUDES EXCESS SAND/GRAVEL)				70. SI&A GENERAL CONDITION RATINGS			
				a. DECK			ITEM 58 5
SUPER STR. (FM. 1 (90)B TRUSS) ITEM 59				b. SUPERSTRUCTURE			ITEM 59 6
10. LONGITUDINAL BEAMS OR GIRDERS				c. SUBSTRUCTURE			ITEM 60 4
11. LONGITUDINAL JOIST OR STRINGERS				d. CHANNEL & CHANNEL PROT.			ITEM 61 7
12. INT. DIAP'S, X-FRAMES, BRACING & CONN'S							
13. END DIAP'S, CURTAIN WALLS, & CONN'S				71. SI&A FIELD APPRAISAL RATINGS			
14. FLOOR BEAMS AND CONNECTIONS				a. WATERWAY ADAQUACY			8
15. BEARING ASSEMBLIES (INCLUDING MISALIGN)				b. APPR. RDWY. ALIGNMENT			8
16. DRAINAGE SYSTEM (ON STRUCTURE)				72. FIELD SCOUR EVALUATION			0
17. MOVABLE SPAN MACHINERY							
SUB STR. ITEMS. ITEM 60 (INCLUDE SCOUR)				USE OF INSP. ACCESSIBILITY EQUIPMENT			
35. TIM SUB STR.				SNOOPER (CODE S, 4, OR N)			HRS NO
a. ABUT. & INT. BENT CAPS & RISERS				LADDER			NO
b. PILES, POST, SILLS, & BRACING				BUCKET TRUCK			NO
c. BULKHEADS, WING'S, & TIE BACKS				BOAT			YES
36. CONC SUB STR.				OTHER			NO
a. ABUT. & INT. BENT CAPS							
b. ABUT. & BENT COL'S BREASTWALLS							
c. ABUT. & INT. BENT PILES							
d. BACKWALLS, WING'S, RETAIN. WALLS							
e. ABUT. & BENT FOOTINGS & SILLS							
37. STEEL SUB STR.				SPECIAL INSPECTION REQUESTED FOR			
a. ABUT. & INT. BENT CAPS & RISERS							
b. PILES, BRACING, AND BULKHEADS							
38. FOUNDATION PILES TYPE MATERIAL				NOTE			
39. SLOPE PROT., RIP-RAP (INCLUDE DRAINAGE)							
40. FENDER SYSTEMS				80. INSPECTED BY:			W.C.G.
41. DRIFT				81. REVIEWED BY:			

BRIDGE INSPECTION RECORD AND SUMMARY FOR SHORED STRUCTURES OR STRUCTURES WITH TEMPORARY REPAIRS MADE TO KEEP A BRIDGE OPEN

BRIDGE: **810233** COUNTY: **Sampson** DATE: **12/22/2008**

THE FOLLOWING S. I. & A ITEMS ARE TO BE CODED TO REFLECT THE FACT THAT THE STRUCTURE IS SHORED OR HAS HAD TEMPORARY REPAIRS MADE TO KEEP THE BRIDGE OPEN :

	<u>CODE</u>	<u>BY</u>
S I & A ITEM 103 - TEMPORARY STRUCTURE DESIGNATION	T	TSE
S I & A ITEM 59 - SUPERSTRUCTURE		
S I & A ITEM 60 - SUBSTRUCTURE	4	TSE <i>12/22/08</i>
S I & A ITEM 64 OPERATING RATING		
HS 0 BY: RPC		
S I & A ITEM 66 - INVENTORY RATING		
HS 0 BY: RPC		

COMMENTS

Helper Bents added in front of End Bents # 1 and # 2. Temporary Repairs.

Bridge I&A Form 1(82)H		FIELD INSPECTION REPORT <u>Bridge Inspection & Analysis</u>	
State of North Carolina Dept. of Transportation Division of Highways			
Team Leader WILLIS C MAY			
Assisted By WTW			
Item No.	Grade		
2a	5	<p>CONCRETE DECK 5 SCALING WITH EXPOSED COARSE AGGREGATE IN BOTH SPANS.</p> <p>SPAN 1 1/8 IN. TRANSVERSE CRACK IN TOP OF DECK SPAN 1 AT END BENT 1. HAIRLINE TO 1/8 LONGITUDINAL CRACK IN TOP OF DECK SPAN 1 SOUTHBOUND LANE. PATCHES IN DECK NEAR END BENT 1 WHERE PILES WERE DRIVEN. SIMILAR IN SPAN 2 AT END BENT 2. 8 IN. DIAMETER SPALL IN BOTTOM OF DECK SPAN 1 BAY 2 AND 9 IN. DIAMETER SPALL IN BOTTOM OF DECK SPAN 1 BAY 18.</p> <p>SPAN 2 1/8 IN. TRANSVERSE CRACK IN TOP OF DECK SPAN 1 AT END BENT 2. HAIRLINE X 8 FT. LONGITUDINAL CRACK IN NORTHBOUND LANE AT BENT 1 AND HAIRLINE X 4 FT. LONGITUDINAL CRACK IN SOUTHBOUND LANE AT BENT 1.</p>	
3a	6	<p>CONCRETE RAILS 6 SCALING WITH EXPOSED COARSE AGGREGATE IN FACES.</p>	
4	6	<p>CURBS 5 SCALING WITH EXPOSED COARSE AGGREGATE IN FACES.</p>	
6d	5	<p>STANDARD JOINTS 5 CRACK IN BENT 1 SEAL NEAR CENTERLINE.</p>	
11	6	<p>LONGITUDINAL JOISTS 6 EXTERIOR JOISTS HAVE LONGITUDINAL CRACKS IN VERTICAL FACES. SPLICE BLOCK IS MISSING AT JOIST 19 OVER BENT 1.</p> <p>SPAN 1 JOIST 5 SPAN 1 AT BENT 1 BOTTOM IS DECAYED 1 IN. DEEP X 3 IN. DIAMETER. JOIST 8 SPAN 1 AT BENT 1 IS DECAYED IN THE END 1 IN. HIGH X 2 IN. WIDE X 4 IN. DEEP.</p> <p>SPAN 2 JOISTS 17 & 18 SPAN 2 HAVE BEEN REPLACED. JOISTS 17 & 18 SPAN 2 ARE NOT BEARING ON END BENT 2 CRUTCH BENT. PRIORITY MAINTENANCE ISSUED</p>	
35a	6	<p>TIMBER CAPS 6 END BENT CAPS ARE ROLLED 1/2 IN TOWARD THE BACKFILL AND NOT BEARING COMPLETELY ON PILES. END BENT 2 CROWNSTRIIP IS DECAYED UNDER JOIST 1 TO JOIST 4 UP TO 8 IN DEEP. STEEL CRUTCH BENTS HAVE BEEN PLACE AT END BENTS. (SEE DRAWINGS)</p>	

Bridge I&A Form 1(82)H		FIELD INSPECTION REPORT <u>Bridge Inspection & Analysis</u>	
State of North Carolina Dept. of Transportation Division of Highways			
Team Leader WILLIS C MAY			
Assisted By WTW			
Item No.	Grade		
35b	4	<p>TIMBER PILES 4 PILE 3 END BENT 1 AND PILE 3 END BENT 2 GRADE 4 , ALL OTHERS GRADE 5. END BENT 1 PILE 3 END BENT 1 IS SPLIT IN THE LEFT AND RIGHT SIDE 3/4 IN. WIDE X 3 FT. LONG WITH 5 IN. OF BEARING REMAINING ON CAP. PILE 3 END BENT 1 IS DECAYED 18 IN. HIGH X 12 IN. WIDE X 2 IN. DEEP IN SPAN 1 SIDE AT WATERLINE . STEEL CRUTCH BENT HAS BEEN PLACED IN FRONT OF ORIGINAL END BENT 1. SEE DRAWING END BENT 2 PILE 3 END BENT 2 IS SPLIT 3/4 IN. WIDE IN X 2 FT. LONG IN THE LEFT AND RIGHT SIDE NEAR THE BACK OF PILE . 4 IN. OF BEARING REMAING ON CAP. STEEL CRUTCH BENT HAS BEEN PLACED IN FRONT OF ORIGINAL END BENT 2. SEE DRAWING</p>	
35c	4	<p>TIMBER BULKHEADS 4 END BENT 1 BULKHEAD AT PILE 3 END BENT 1 IS PUSHED IN TOWARD STREAM . PILE IS SPLIT AND HAS LOSS OF BEARING. BULKHEAD BOARD # 3 DECAYED 2 IN. DEEP FROM RIGHT END OF CAP TO END. BULKHEAD BOARD # 5 BELOW BOTTOM OF CAP DECAYED THROUGH WITH EXPOSED FILL FROM PILE 3 TO PILE 4. RIGHT WINGWALL BOARDS # 3 & 7 ARE MISSING WITH EXPOSED FILL. 18 IN X 3 IN X 3 IN DEEP DECAY IN RIGHT WINGWALL PILE AT END BENT 1. END BENT 2 ENDS OF LEFT WINGWALL DECAYED BACK 1 FT. BULKHEAD AT PILE 3 END BENT 2 IS PUSHED IN TOWARD STREAM . PILE IS SPLIT AND HAS LOSS OF BEARING. RIGHT END OF BULKHEAD BOARDS DECAYED BEHIND RIGHT BULKHEAD PILE. SPOTS OF DECAY 2 IN. DEEP IN BULKHEAD BOARDS FROM PILE 2 TO PILE 4. 18 IN X 3 IN X 3 IN DEEP DECAY IN RIGHT WINGWALL PILE AT END BENT 1. TOP 2 RIGHT SIDE WINGWALL BOARDS MISSSING.</p>	
39	5	<p>SLOPE PROTECTION 5 VEGETATION OVERGROWTH AT ENDS OF BRIDGE.</p>	
50	6	<p>APPROACH ROADWAY CONDITION 6 APPROACH 1 TRANSVERSE CRACKS, PATCH, AND 1 1/2 IN. SETTLEMENT AT END BENT 1. APPROACH 2 TRANSVERSE CRACKS, PATCH, AND 1 IN. SETTLEMENT AT END BENT 2.</p>	
61	YES	JOISTS 17 & 18 NOT BEARING AT END BENT 2 CRUTCH.	
62	YES	WEIGHT LIMIT 25 TONS.	





BRIDGE INSPECTOR'S RECOMMENDATION FOR MAINTENANCE REPAIRS

Bridge: 810233

County SAMPSON

Date: 07/22/2010

These Repairs Should Be Made Within Twelve Months From Date Of This Inspection

MMS Code	Description of Function	Unit	Quantity	Remarks	Est. Cost
2816	Asphalt Surface Repair or Replacement	SY	120	APPROACHES CRACKED, PATCHED, AND SETTLED.	
2910	Manual Brush and Tree Control	LF	80	VEGETATION COVERING WINGWALLS.	
 3304	Maintain/Replace Timber Superstructure Components	LF	2 TSC 8/17/10	JOIST 17 SPAN 2 NOT BEARING ON END BENT 2 CRUTCH BENT. JOIST 18 SPAN 2 NOT BEARING ON END BENT 2 CRUTCH BENT.	
 3304	Maintain/Replace Timber Superstructure Components	LF	38	DECAY IN JOIST 5 & 8 SPAN 1 OVER BENT 1. SPLICE BLOCK IS MISSING AT JOIST 19 OVER BENT 1.	
 3310	Maintenance/Repair/Replacement of Standard Bridge Expansion Joints	LF	24	BENT 1 EXPANSION JOINT CRACKED.	
 3346	Repair / Maintain Timber Wings & Blkhds	SF	225	BULKHEAD AND WINGWALL BOARDS DECAYED AND MISSING WITH EXPOSED FILL.	

Key

 Priority Maintenance Item

 Critical Finding Item

 Priority Maintenance Level Not Determined

BRIDGE INSPECTOR'S RECOMMENDATION FOR PRIORITY MAINTENANCE REPAIRS

Bridge: 810233 County SAMPSON

THE FOLLOWING MAINTENANCE ITEMS HAVE BEEN SUBMITTED IN CONJUNCTION WITH A PRIORITY MAINTENANCE REQUEST

MMS Code	MMS Description	Quantity
3304	Maintain/Replace Timber Superstructure Components	2 LF
Location:		
Beams and Girders	Bent/Span No. 2	JOIST 17
Priority Level	Status	
Priority Maintenance	SIA Updates in Process	
Submitted Date:	Submitted By:	Assisted By:
07/22/2010	WILLIS C MAY	WAYNE T WILKINSON
Details		
JOIST 17 SPAN 2 NOT BEARING ON END BENT 2 CRUTCH BENT. JOIST 18 SPAN 2 NOT BEARING ON END BENT 2 CRUTCH BENT.		



APPROACH 1 MAP CRACKED



APPROACH 1 PATCHED AND SETTLED IN THE RIGHT LANE



TRANSVERSE CRACK IN TOP OF DECK AT END BENT 1



LONGITUDINAL CRACK IN THE LEFT LANE OF SPAN 1



TOP OF DECK SCALED WITH COARSE AGGREGATE EXPOSED



LONGITUDINAL CRACK IN THE RIGHT SIDE SHOULDER OF SPAN 2

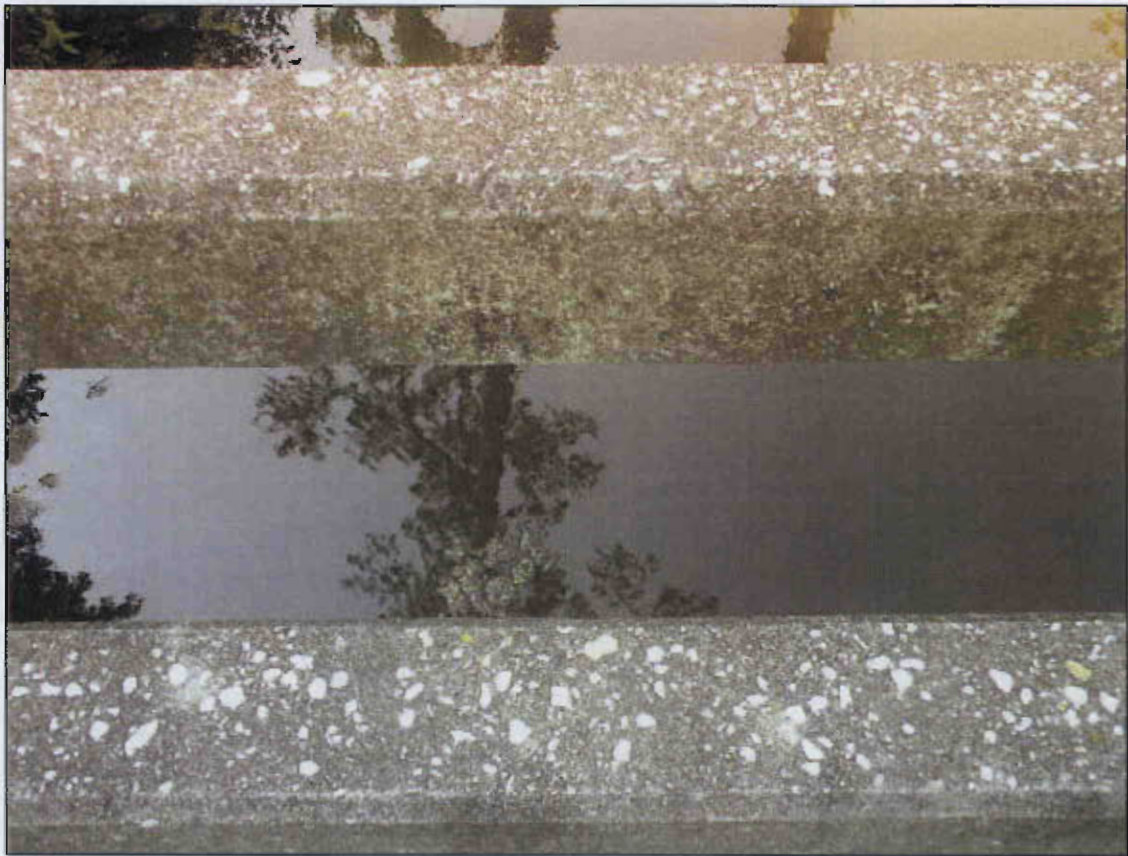

CURBS AND GUARDRAILS SCALED WITH EXPOSED AGGREGATE



TRANSVERSE CRACK IN SPAN 2 AT END BENT 2



APPROACH 2 PATCHED AND SETTLED IN THE RIGHT LANE AT END BENT 2



APPROACH 2 MAP CRACKED



NO BEARING AT JOIST NO.17 OVER END BENT 2 CRUTCH (PRIORITY MAINTENANCE ISSUED)



NO BEARING AT JOIST NO.18 OVER END BENT 2 CRUTCH (PRIORITY MAINTENANCE ISSUED)



DECAY IN BULKHEAD BOARDS BETWEEN PILE 2 AND 3 AT END BENT 2



MISSING SPLICE BLOCK AT THE RIGHT SIDE OF INTERIOR BENT



DECAY IN BULKHEAD BOARDS BETWEEN PILE 3 & 4 AT END BENT 1



DECAY IN BOTTOM OF JOIST 5 IN SPAN 1 OVER INTERIOR BENT



DECAY IN END OF JOIST 8 IN SPAN 1 OVER INTERIOR BENT



MISSING BOARDS FROM THE RIGHT WINGWALL AT END BENT 1



DECAY IN ENDS OF THE LEFT WINGWALL BOARDS AT END BENT 1

BRIDGE MANAGEMENT UNIT
 DATA ON EXISTING STRUCTURE

Run Date: 08/19/2010

COUNTY : SAMPSON DIV : 3 DIST : 2 STRUCTURE NUMBER : 810233 LENGTH : 36 FEET

ROUTE CARRIED : SR1742 FEATURE INTERSECTED : SIX RUN CREEK

LOCATED : 0.6 MI.N.JCT SR1740 BRIDGE NAME : CITY :

FUNC. CLASS : 09 SYST.ON : NFA SYST.UNDER : NFA ADT & YR : 500 2008 RAIL TYPE : LT 241 RT 241

BUILT : 1952 BY : BMU PROJ : FED.AID PROJ : DESIGN LOAD : Other or Unknown

REHAB : BY : PROJ : ALIGNMENT : TAN 90 SKEW : LANES : ON 2 UNDER

NAVIGATION : VC 0.0 FT HT. CRN. TO BED : 10 FT WATER DEPTH : 6 FT

SUPERSTRUCTURE : RC FLOOR/TIMBER JOISTS(STD.BMD-10)

SUBSTRUCTURE : E.BTS&BT:TIM.CAPS/TIM.PILES;CRUTCH ADDED @E.BTS.

SPANS : 1@17'6;1@18'2

BEAMS OR GIRDERS : 19LINES 6X12 TIMBER-JOISTS @ VARYING CTS.

FLOOR : 5 RC/NO AWS ENCROACHMENT : DECK (OUT TO OUT) : 25.3 FT

CLEAR ROADWAY : 24.0 FT BETWEEN RAILS : 25.5 FT SIDEWALK OR CURB : LT 0.8 FT RT 0.8 FT

VERT.CL.OVER : 99 FT 99 IN VERT.CL.UNDER : 00 FT 00 IN HOR.CL.UNDER : 0.0 FT

INV.RTG. : HS-1 OPE.RTG. : HS-1 CONTR.MEMBER : JOIST INT. POSTED : SV 25 TTST LGW DATE 01/14/2009

SYSTEM : Secondary S.R. Route GREEN LINE ROUTE : N

2ND OPENING : 3RD OPENING : 4TH OPENING : 5TH OPENING :

REMARKS :

Structure Data Worksheet

Spans

County: SAMPSON

Structure No: 810233

Date: 07/22/2010

Inspected By: WCM

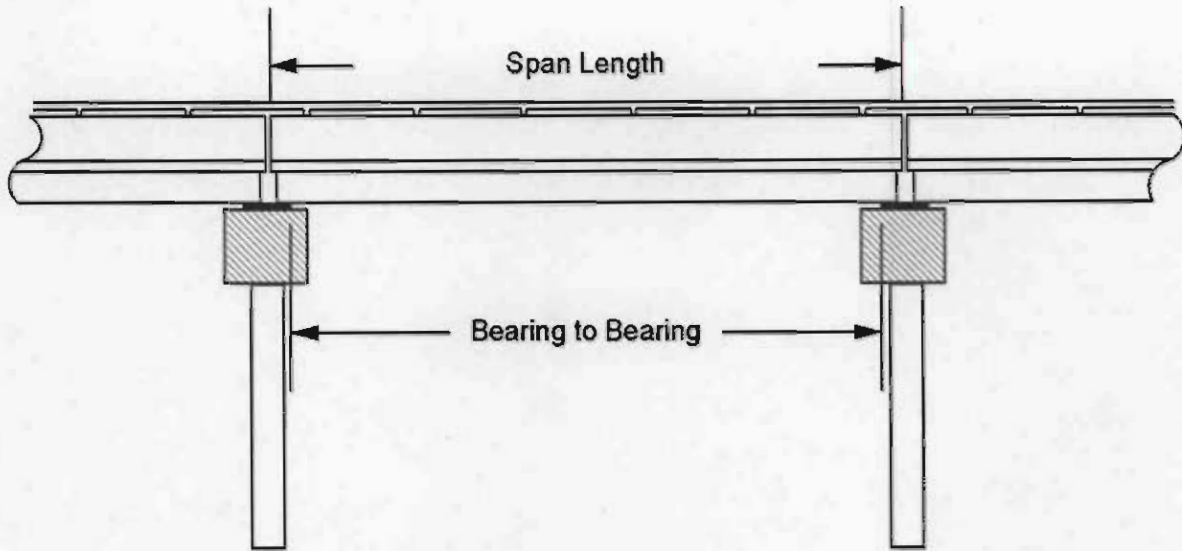

Span No	Span Length	Bearing to Bearing	Comments
1	17.5	15.583	
2	18.1667	16.333	

Stream Bed Soundings

(See next sheet for profile sketch)

Bridge No: 810233 County: SAMPSON Date: 07/22/2010 By: WCM

Record sounding from top of rail. Other location if needed: _____

Distance from Highwater Mark to top of rail: _____ Location of Highwater Mark: _____

DOWNSTREAM			UPSTREAM		
Distance (Station) (ft)	Sounding (ft)	Description	Distance (Station) (ft)	Sounding (ft)	Description
0	0	TOP OF RAIL			
1	3.9	TOP OF CAP			
1.1	8.5	Water Surface/Water Edge (WSWE)			
1.2	14.2	END BENT 1	1.2	8.7	END BENT 1
10	13.4				
18	13.8	BENT 1	18	12.2	BENT 1
25	12.2				
34.8	10.1	END BENT 2	34.8	12.3	END BENT 2
34.9	8.5	Water Surface/Water Edge (WSWE)			
35	3.9	TOP OF CAP			
36	0	Top of Cap			

Top of Rail = 0 FT (Sounding)

STREAMBED PROFILE (Downstream)

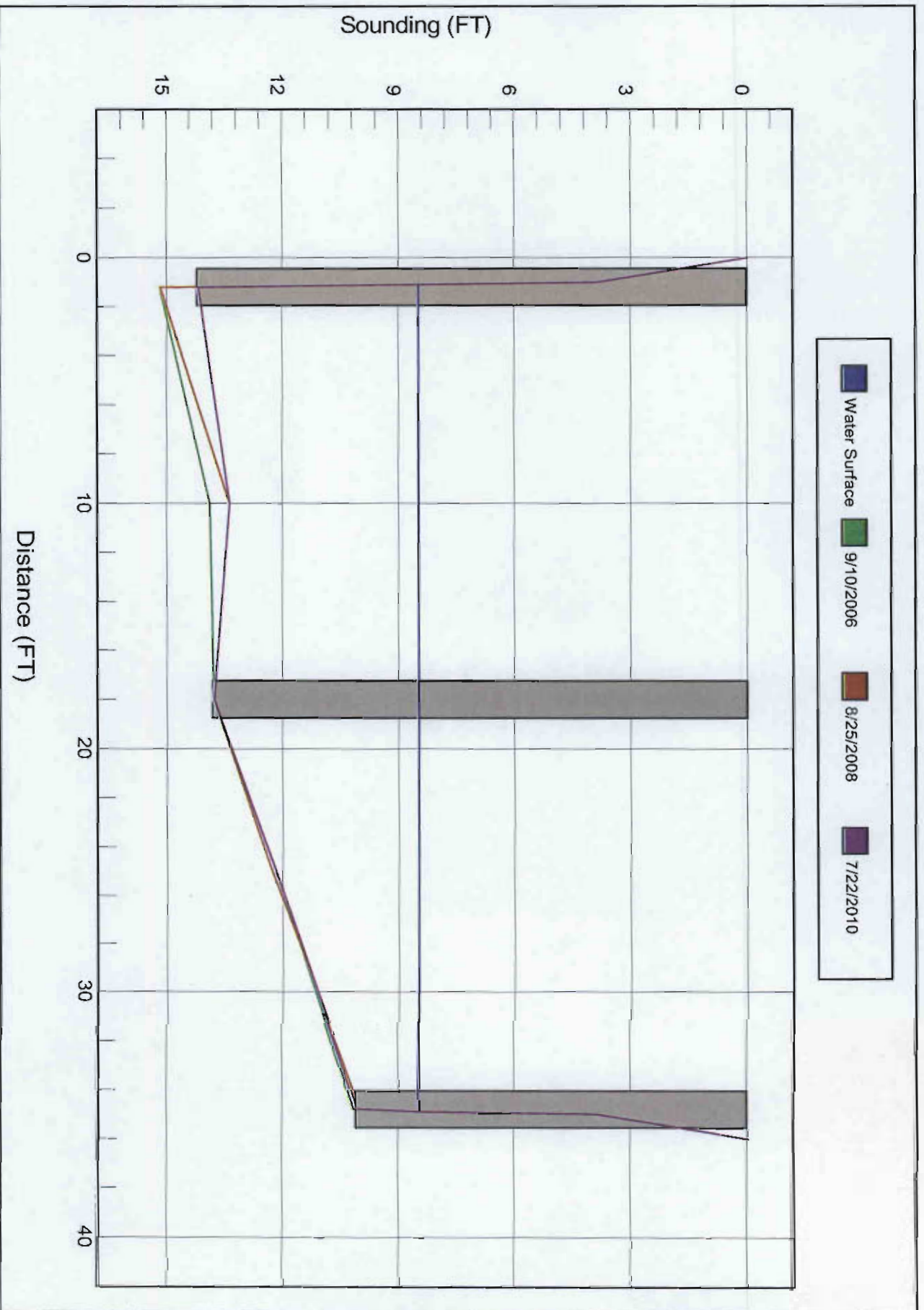

Bridge Inspection Field Sketch



Roadway	18ft Wide	2 Paved Lanes	Looking North
Left Shoulder	6ft Wide		6ft Unpaved
Right Shoulder	6ft Wide		6ft Unpaved
Left Guardrail			
Right Guardrail			

CHECKED BY: WTW 7/21/10

Title

APPROACH ROADWAY

Description

LOOKING NORTH

Bridge No: 810233

Drawn By: WCM

Date: 8/25/08

File Name: S0242000982

Bridge Inspection Field Sketch

Deck Width/Out to Out	25.3333	Wearing Surface	
Between Rails	25.5ft	Median Width	
Curb Height	.75ft	Median Height	
Top Rail to Deck/Wearing Surface	2.6667ft	Left Guardrail Width	.6667ft
Clear Roadway	24.0ft	Right Guardrail Width	.6667ft
Left Bridge Rail	Type 14	Right Bridge Rail	Type 14

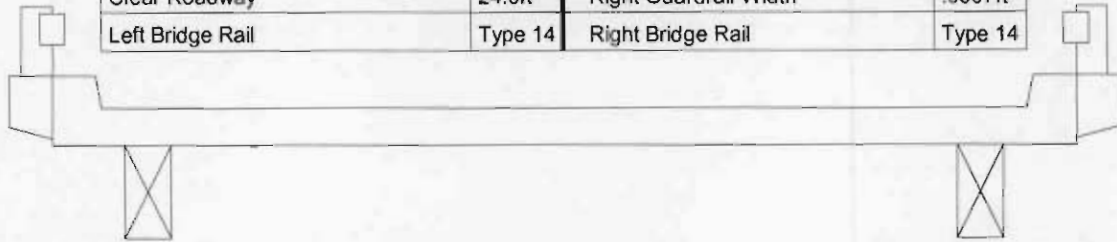

Measurements for Span #	1		
Deck Thickness	.4167	Left Overhang	.4583
Top of Rail to Bottom of Beam	4.0833	Right Overhang	.4583

Beam No	Beam Type	Spacing	Comments
1	Timber (Rectangular)	1.3333ft	6 X 12 TIMBER JOIST
2	Timber (Rectangular)	1.3333ft	6 X 12 TIMBER JOIST
3	Timber (Rectangular)	1.3333ft	6 X 12 TIMBER JOIST
4	Timber (Rectangular)	1.3333ft	6 X 12 TIMBER JOIST
5	Timber (Rectangular)	1.3333ft	6 X 12 TIMBER JOIST
6	Timber (Rectangular)	1.3333ft	6 X 12 TIMBER JOIST
7	Timber (Rectangular)	1.3333ft	6 X 12 TIMBER JOIST
8	Timber (Rectangular)	1.3333ft	6 X 12 TIMBER JOIST
9	Timber (Rectangular)	1.3333ft	6 X 12 TIMBER JOIST
10	Timber (Rectangular)	1.3333ft	6 X 12 TIMBER JOIST
11	Timber (Rectangular)	1.3333ft	6 X 12 TIMBER JOIST
12	Timber (Rectangular)	1.3333ft	6 X 12 TIMBER JOIST
13	Timber (Rectangular)	1.3333ft	6 X 12 TIMBER JOIST
14	Timber (Rectangular)	1.3333ft	6 X 12 TIMBER JOIST
15	Timber (Rectangular)	1.3333ft	6 X 12 TIMBER JOIST
16	Timber (Rectangular)	1.3333ft	6 X 12 TIMBER JOIST
17	Timber (Rectangular)	1.3333ft	6 X 12 TIMBER JOIST
18	Timber (Rectangular)	1.75ft	6 X 12 TIMBER JOIST
19	Timber (Rectangular)		6 X 12 TIMBER JOIST

CHECKED BY: WTW 7/21/10

Title

TYPICAL SECTION

Description

19 LINES OF TIMBER JOISTS

Bridge No: 810233

Drawn By: WCM

Date: 8/25/08

File Name: S0242000983

Bridge Inspection Field Sketch

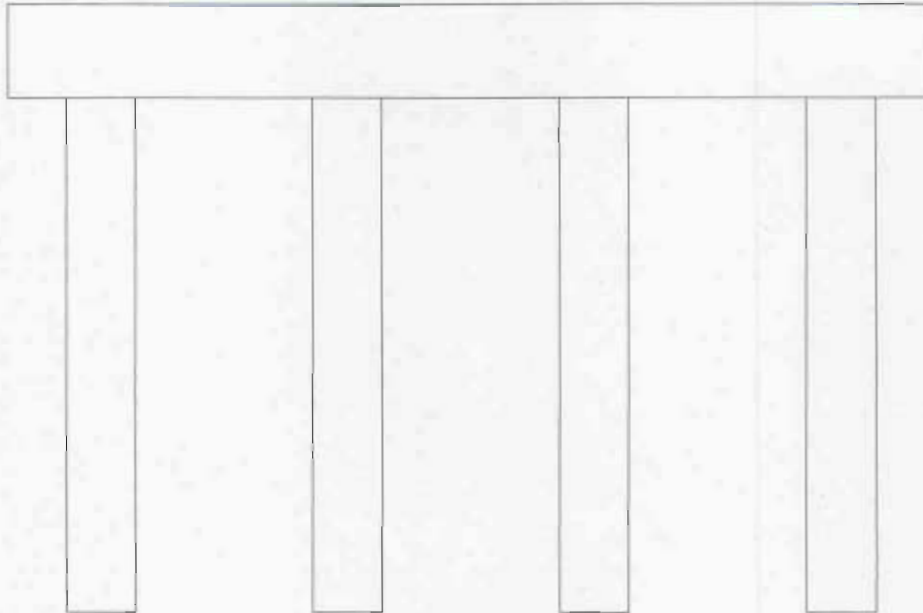

Abutment #	1	Abutment 2 and Bent similar	
Cap - Beam Type (Wood or Steel)			
Cap Size	26.0ft Long	1.0ft Wide	1.0ft High
Left Overhang	1.0ft	Lt Cap/Beam Overhang	.7917ft
Right Overhang	1.0ft	Rt Cap/Beam Overhang	.7917ft

Pile #	Material	Pile Type	Spacing	Length	Width/Diam.	Height	Orientation
1	Wood or Timber	Pile Bent	8.0		1.0		Vertical
2	Wood or Timber	Pile Bent	8.0		1.0		Vertical
3	Wood or Timber	Pile Bent	8.0		1.0		Vertical
4	Wood or Timber	Pile Bent			1.0		Vertical

CHECKED BY: WTW 7/21/10

Title PILE DIAGRAM	Description END BENTS AND BENT
Bridge No: 810233	Drawn By: WCM
Date: 8/25/08	File Name: S0242000984

Bridge Inspection Field Sketch

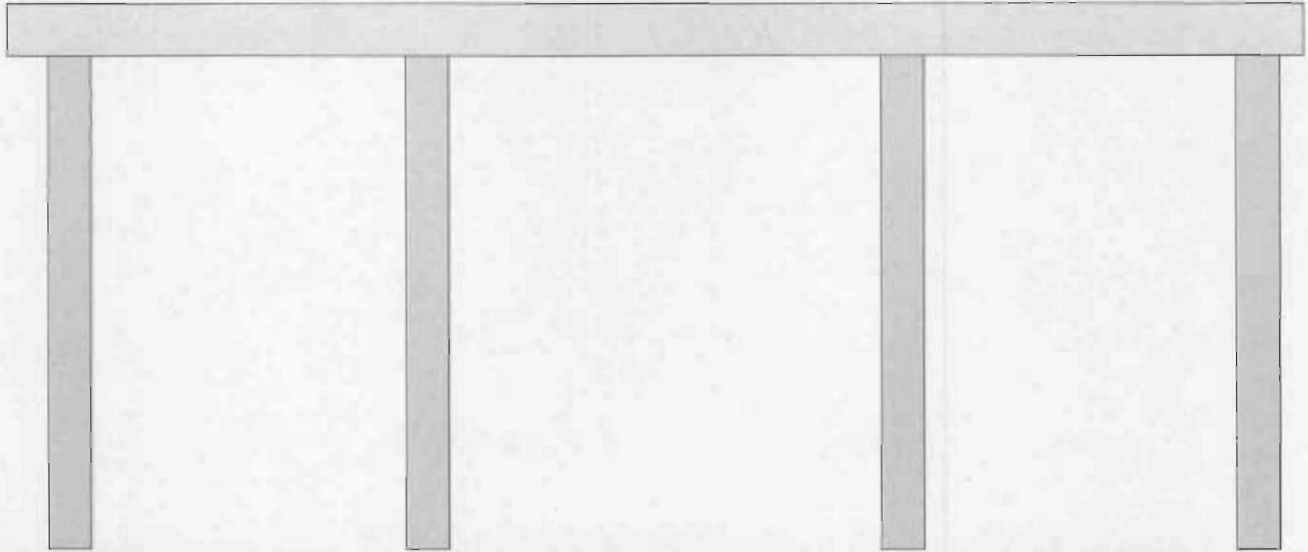

Cap Information			Material							
Length	Width	Height	Left Overhang	Right Overhang	Left Beam to End of Cap.	Right Beam to End of Cap.				
25.250 ft.	1.0 ft.	1.0 ft.	1.208 ft.	.875 ft.	.417 ft.	.417 ft.				
Subcap Information			Material							
Length	Width	Height	Left Overhang	Right Overhang	Left Pile to Splice.					
Sill Information			Material							
Length	Width	Height								
Pile #	Material	Spacing	Width/Dia.	Height	Length	Orientation	Driven?	Replacement?	Removed?	Collar?
1	Steel	7.000 ft.	0.833 ft.			Vertical	Yes	No	No	No
2	Steel	9.250 ft.	0.833 ft.			Vertical	Yes	No	No	No
3	Steel	6.917 ft.	0.833 ft.			Vertical	Yes	No	No	No
4	Steel		0.833 ft.			Vertical	Yes	No	No	No
Bent/Abutment #: 1			Similar Bents:							

Title END BENT 1 CRUTCH	Description END BENT 1 CRUTCH
Bridge No: 810233	Drawn By: WCM
Date: 7/21/2010	File Name: S0014003911

Bridge Inspection Field Sketch

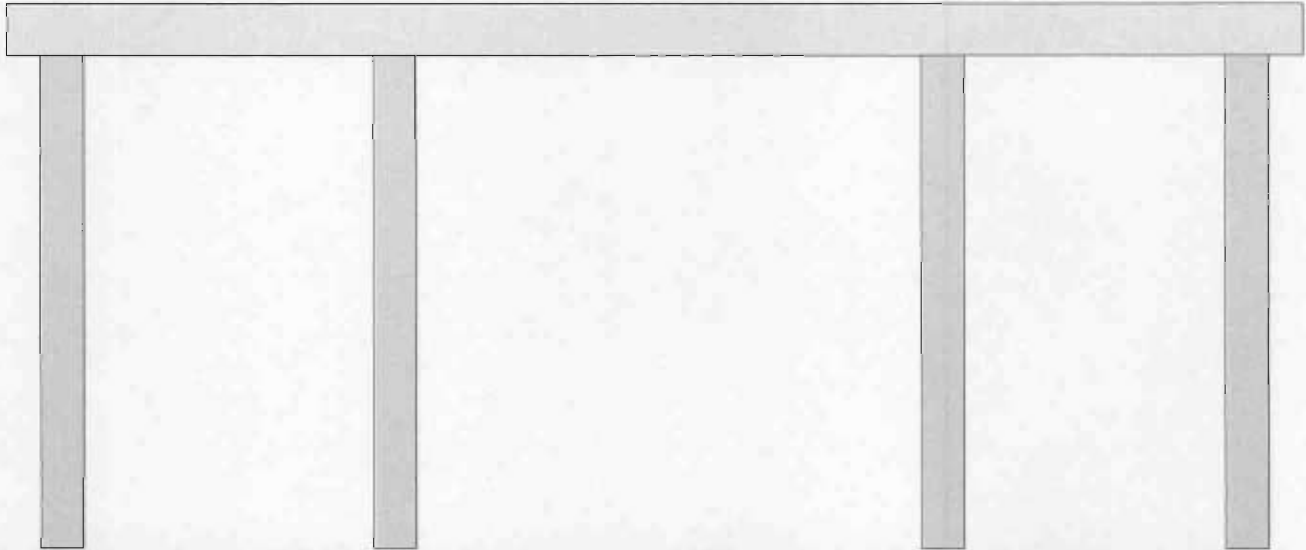

Cap Information			Material			
Length	Width	Height	Left Overhang	Right Overhang	Left Beam to End of Cap.	Right Beam to End of Cap.
25.250 ft.	1.0 ft.	1.0 ft.	1.083 ft.	1.083 ft.	.417 ft.	.417 ft.

Subcap Information			Material		
Length	Width	Height	Left Overhang	Right Overhang	Left Pile to Splice.

Sill Information			Material		
Length	Width	Height			

Pile #	Material	Spacing	Width/Dia.	Height	Length	Orientation	Driven?	Replacement?	Removed?	Collar?
1	Steel	6.5 ft.	0.833 ft.			Vertical	Yes	No	No	No
2	Steel	10.667 ft.	0.833 ft.			Vertical	Yes	No	No	No
3	Steel	5.917 ft.	0.833 ft.			Vertical	Yes	No	No	No
4	Steel		0.833 ft.			Vertical	Yes	No	No	No

Bent/Abutment #: 2 Similar Bents:

Title END BENT 2 CRUTCH	Description END BENT 2 CRUTCH
Bridge No: 810233	Drawn By: WCM
Date: 7/21/2010	File Name: S0014003912

Bridge Inspection Field Sketch

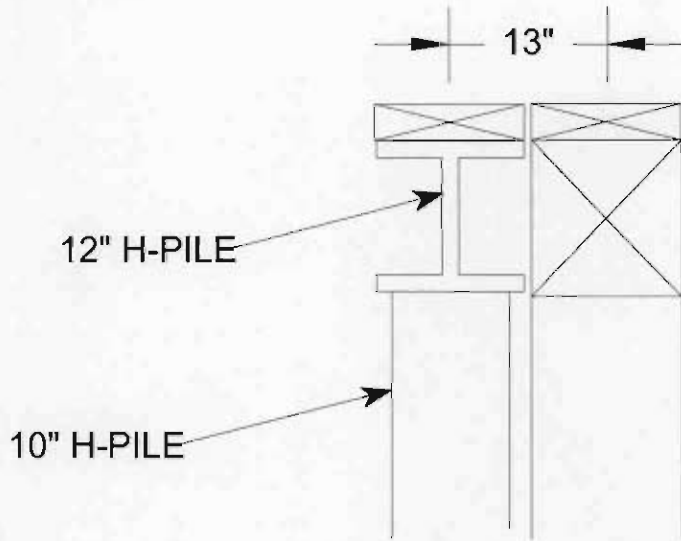

LEFT END OF END BENT 1

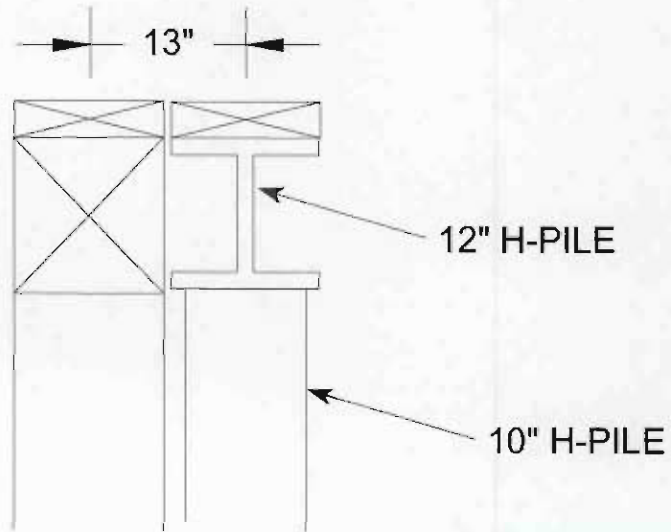

LEFT END OF END BENT 2

Title
CRUTCH BENTS

Description
END VIEW

Bridge No: 810233

Drawn By: WCM

Date: 7/22/2010

File Name: S0014003913

Bridge Inspection Field Sketch

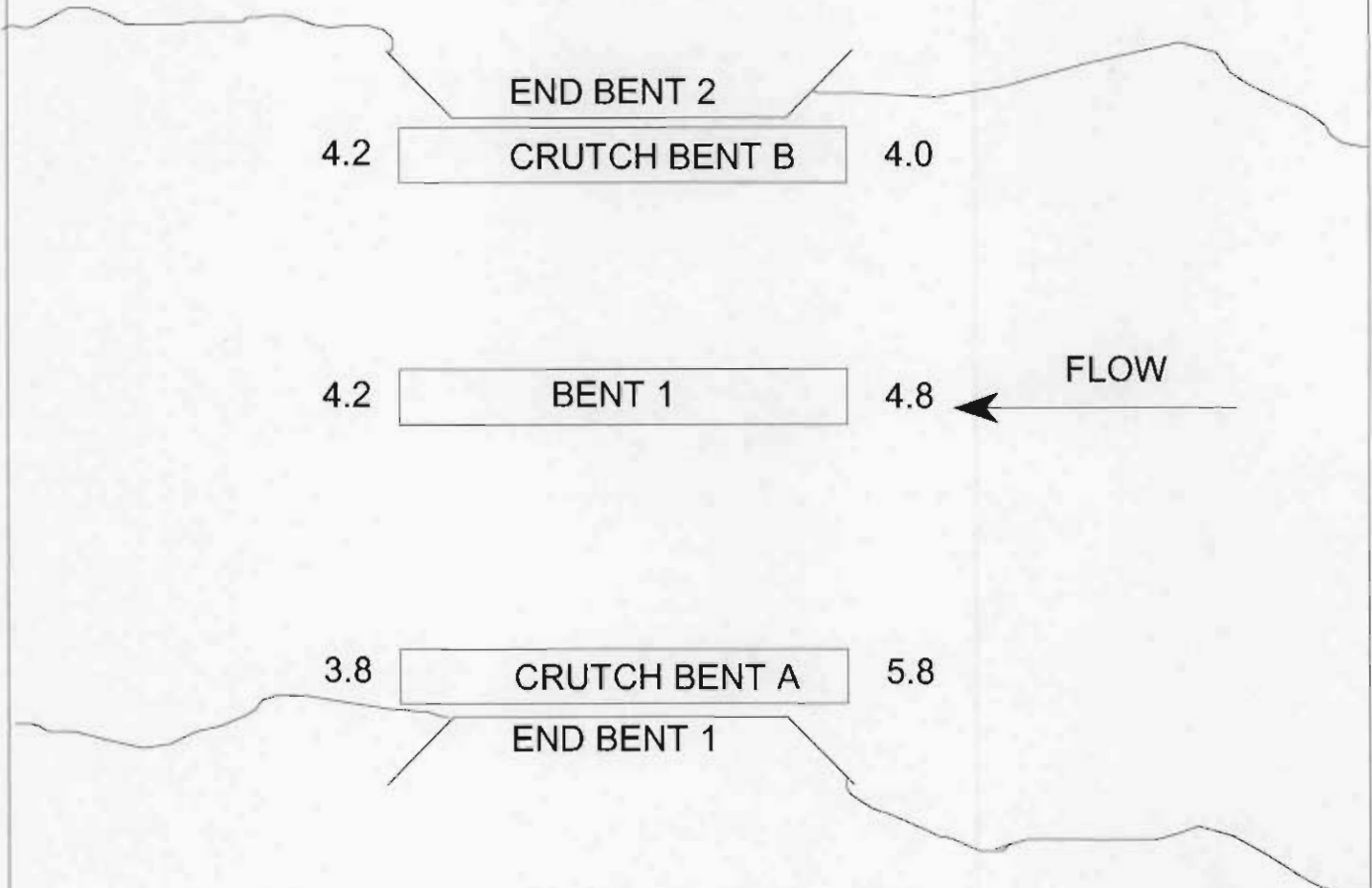

W/S: 8.5 FT AT BENT 1, WEST SIDE
 BOTTOM COMP: SAND AND SILT OVER STIFF CLAY
 PROBE: 0.5 FT

Title WATERWAY		Description PLAN VIEW	
Bridge No: 810233	Drawn By: JVB	Date: 7/29/2010	File Name: S0158000857



LOOKING NORTH



JOINT AT INTERIOR BENT



LOOKING WEST UPSTREAM



LOOKING EAST DOWNSTREAM



PATCH IN THE RIGHT SIDE OF SPAN 2 AT END BENT 2



LOOKING SOUTH



WEIGHT POSTING



EAST PROFILE



END BENT 1 OVERVIEW



WEST PROFILE



END BENT 2 OVERVIEW



INTERIOR BENT SPAN 2 SIDE



SUPERSTRUCTURE OVER END OF CAP



SUPERSTRUCTURE OVERVIEW



TOP OF DECK OVERVIEW